

Fitting Instructions

Loftcap

ALC275 Loftcap

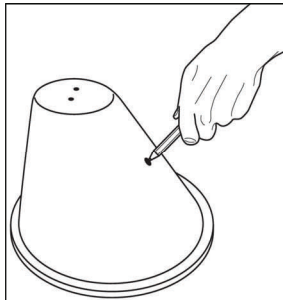

STEP ONE

Make a small hole or slit in the Loftcap for the cable

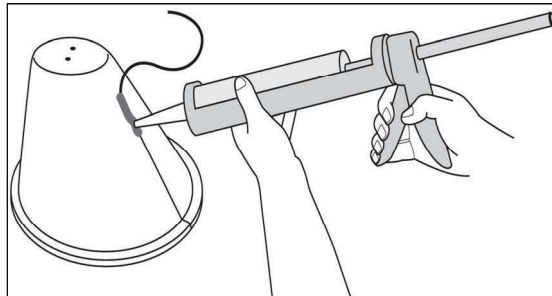

STEP TWO

After placing the Loftcap over the downlight, pass the cable through the hole/slit and seal with silicone sealant

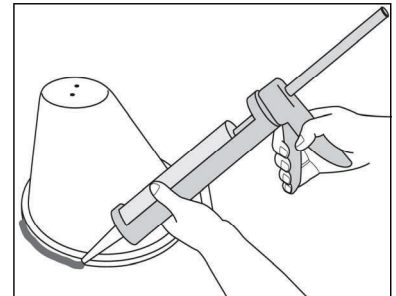

STEP THREE

Seal around the base of the Loftcap with silicone sealant to secure it in place

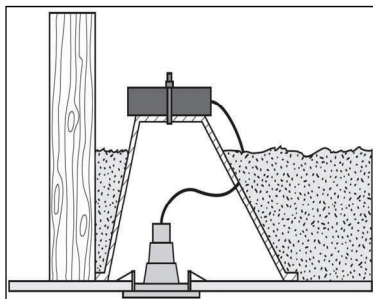

STEP FOUR

If insulation level does not completely cover the Loftcap, the transformer can be located on the top of the Loftcap, securing with a nylon cable tie

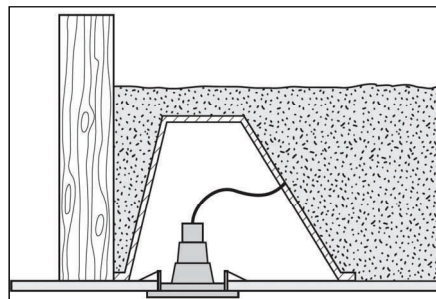

STEP FIVE

If insulation will cover the Loftcap, the transformer must be mounted clear of the insulation following the transformer manufacturers instructions

Hints & Tips

- Loftcaps are "F Capped"  Approved—can be buried under insulation
- ALC275 Loftcaps are suitable for cut-out diameters of 70–110mm
- Ensure transformer is mounted clear of the insulation
- Max. Lamp wattage 50W
- Downlight should not touch inside of Loftcap
- Downlights must be fitted as per the manufacturers recommendations
- The Loftcap is approved for installation in contact with combustible surfaces e.g. Timber. The downlight must be at least 25mm away from the joist (shown on the right)

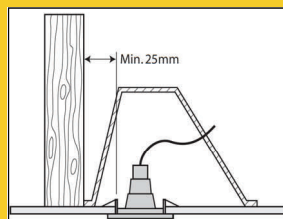

Need
some help?
Call 0870 758 4000



Mile End Business Park, Oswestry, Shropshire SY10 8NN

Tel. 0870 758 4000

Fax. 0870 758 4010

www.aico.co.uk

E & OE Our policy is one of continuous improvement.

We reserve the right to amend designs and specifications without prior notice.

ALC275 Fitting Instructions Rev 0 12.08.10

Aico Ltd is a wholly owned subsidiary of Ei Electronics



Europe's Leader in Residential Fire + Gas Detection

Ei Electronics, Shannon, Ireland



Made in
Ireland